

Rev.	No.	Item	Revision	Date	Drawn	Appr.
A			Initial drawing	15-05-01	JwvdK	
B	1		Self-cleaning hole added	12-08-02	JwvdK	
C	1		Self cleaning hole removed again	24-03-06	JwvdK	
D	1		dimple made in bottom of cup	19-09-06	NO	
E	1		Adjusted no of small balls after samples	29-10-06	NO	
F	1		Adjusted after manufacturer remark	05-06-07	JwvdK	

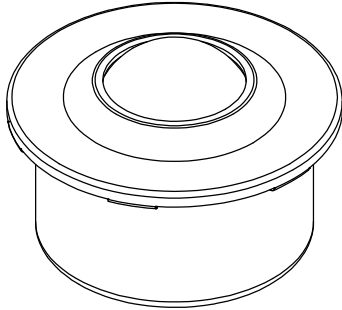

Load rating : 130 daN

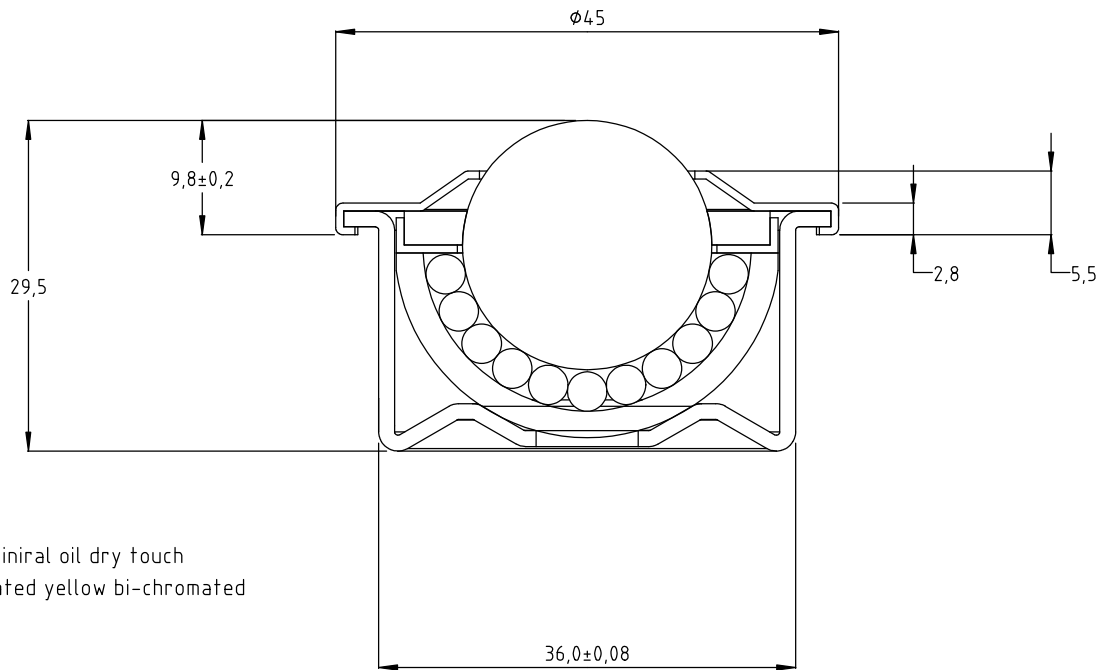

Lubricated with mineral oil dry touch
Housing : Zinc-plated yellow bi-chromated

BE AWARE OF MIXTURE OF SMALL BALLS.

Part	Qty	Description	Material	(surface) treatment	PartID	Version
A	1	Main ball $\phi 7/8''$	bearing steel	Hardened (min 60 HRC)		
B	1	Top cover (stamped)	Sheet steel (Q235)	Zinc-plated (yellow bi-chromated)	80110-1	D
C	1	Velt ring	Velt (3 mm thick)			
D	1	Retainer / washer (stamped)	Sheet steel Q235 (0.5 mm)	Zinc-plated (yellow bi-chromated)	88110-1	D
E	1	Hardened cup	Sheet steel (2,5 mm)	Hardened HV 450-550	80110-1	D
F	1	Stamped housing	Sheet steel (Q235, 1,2 mm)	Zinc-plated (yellow bi-chromated)	80110-1	D
G	73	small balls $\phi 3,175$	bearing steel	Hardened (min. 60 HRC)		
H	23	balls $\phi 3$ mm	bearing steel	Hardened (min. 60 HRC)		

Drawn JwvdK	Appr.	Tolerances acc. $\pm 0,1 / \pm 2^\circ$	Scale 1,5:1	Projection 	Size A4
Description Plate steel ball transfer unit main ball 22 mm			Status Production	Date 05-06-2007	
 MultiComponents Montfoort (NL)			MCBCode MCB80110		Rev. F
			Drawing No. 80110-0		
This drawing is property of MultiComponents International B.V. and must not be copied or shown to third parties without our prior written consent					