

# Backlash-free Servo-insert Coupling Series ASS/B-ZW

## type Line Shaft

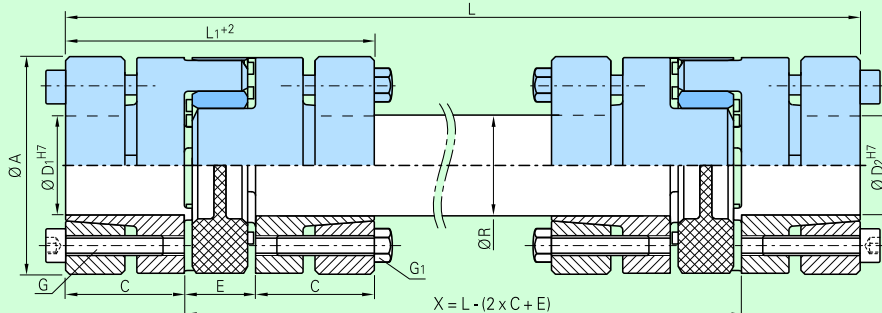

### Technical Data Series ASS/B-ZW

Type			14	19	24	28	38	42	48
Nominal torque	(Nm)	T <sub>KN</sub> (98ShA)	12,5	17	60	160	325	450	525
Tightening torque of screws	(Nm)	MA G/G <sub>1</sub>	1,8	3	6	6	10	35	69
Torsional stiffness (tube)	(Nm/rad)	C per m	70	130	950	1.800	5.200	11.800	17.500
Max. speed	(min <sup>-1</sup> )	n <sub>max</sub>	1.500	1.500	1.500	1.500	1.500	1.500	1.500
Standard shore hardness			98 SH A (red)						
Misalignment			see page 10						

### Dimensions (mm) Series ASS/B-ZW

Type		14	19	24	28	38	42	48
L	(max.)	3.000	3.000	3.000	3.000	3.000	3.000	3.000
L <sub>1</sub>		50	66	78	90	114	126	140
A		32	40	55	65	80	95	105
C		18,5	25	30	35	45	50	56
Ø D <sub>1</sub> H <sub>7</sub> / Ø D <sub>2</sub> H <sub>7</sub>	min. - max.	6-14	10-20	11-25	15-36	20-41	27-50	30-55
E		13	16	18	20	24	26	28
R (steel precision tube)		10	12	20	25	32	40	45
G (DIN 912)		M3	M4	M5	M5	M6	M8	M10
G <sub>1</sub> (DIN 931)		M3	M4	M5	M5	M6	M8	M10
Hub material		Al	Al	Al	Al	Al	St	St

**More length dimensions upon request!** Please ask for technical advice if you require higher speeds, bigger fitting lengths or if you install the coupling in a vertical way. To facilitate the assembly we recommend to keep the distance dimension X of the shaft. A tube with a shift fit is also available. For more information see the catalogue [Backlash-free Servo-insert Couplings](#).

### Bore range D1/D2 and corresponding transmissible torque values (Nm) of the coupling

Type	Ø 6	Ø 10	Ø 11	Ø 13	Ø 14	Ø 15	Ø 17	Ø 19	Ø 20	Ø 24	Ø 25	Ø 27	Ø 30	Ø 32	Ø 36	Ø 38	Ø 41	Ø 42	Ø 44	Ø 48	Ø 50	Ø 55
14	3,6	12,5	12,5	12,5	12,5																	
19		17	17	17	17	17	17	17	17													
24			22	37	46	56	60	60	60	60	60											
28						56	68	114	134	160	160	160	160	160								
38									134	230	261	325	325	325	325	325	325					
42												329	450	450	450	450	459	450	450	450	450	450
48													450	525	525	525	525	525	525	525	525	525

### Ordering data

**ASS/B-ZW 14/80** - **4H7** - **10H7** - **xxxxx**

Type/total length

Bore size D<sub>1</sub>

Bore size D<sub>2</sub>

Additional details, e.g. different shore hardness, keyway

- For higher torque transmission
- Well suited for alternating loads
- Electrically isolating, vibration damping
- Backlash-free
- Fail-safe design

**GERWAH®**