

TSCHAN® Elastomer Coupling

Type S-St

Coupling with standard hub

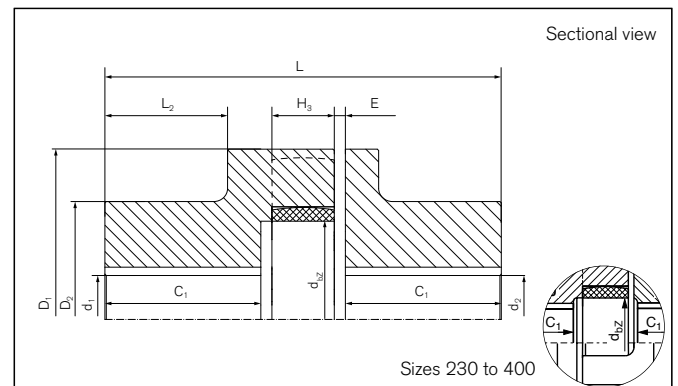

Dimensions / Technical data

- | | | |
|--|---|---|
| T_{KN} = Nom. transmissible torque | D₁ = Outer diameter hub | H₃ = Length of damping module |
| T_{Kmax} = Max. transmissible torque of the coupling | D₂ = Outer diameter hub | d_{bz} = Inner diameter elastomeric spider |
| n_{max} = Max. rotation speed | C₁ = Guided length in hub bore | G_{wub} = Weight, unbored |
| d_{1f max} = Max. bore diameter d ₁ with keyway acc. to ANSI B17.1 | L = Total length | |
| d_{2f max} = Max. bore diameter d ₂ with keyway acc. to ANSI B17.1 | L₂ = Length on the hub | |
| | E = Gap width between left and right component | |
| | F_E = Tolerance of the gap width E | |

Identifier	Size	T _{KN}	T _{Kmax}	n _{max}	d _{1f max}	d _{2f max}	D ₁	D ₂
		Nm	Nm	1/min	mm	mm	mm	mm
WS0105	50	15	40	15000	25	25	50	41
WS0107	70	55	160	11000	38	38	70	55
WS0108	85	75	225	9000	40	40	85	60
WS0110	100	130	390	7250	48	48	105	75
WS0112	125	250	750	6000	55	55	126	85
WS0114	145	400	1200	5250	65	65	145	95
WS0117	170	630	1900	4500	85	85	170	120
WS0120	200	1100	3300	3750	95	95	200	135
WS0123	230	1700	5150	3250	105	105	230	150
WS0126	260	2650	7950	3000	125	125	260	180
WS0130	300	3900	11700	2500	140	140	300	200
WS0136	360	6500	19500	2150	150	150	360	210
WS0140	400	8900	26700	1900	160	160	400	225

To continue see next page

TSCHAN® Elastomer Coupling

Type **S-St**

Identifier	Size	C ₁	L	L ₂	E	F _E	H ₃	d _{bz}	G _{wub}
		mm	mm	mm	mm	mm		mm	kg
WS0105	50	30	75	23,5	1,5	+ 1,0	12	19	0,8
WS0107	70	38,5	100	31,5	2,5	+ 1,5	18	26	1,8
WS0108	85	43,5	110	35	2,5	+ 2,0	18	38	2,7
WS0110	100	49,5	125	37,5	3	+ 2,0	20	42	4,9
WS0112	125	56,5	145	44	3,5	+ 2,5	25	54	7,5
WS0114	145	61	160	47,5	4	+ 2,5	30	66	10,6
WS0117	170	75	190	60,5	5	+ 3,0	30	90	18,0
WS0120	200	99	245	79,5	6	+ 3,0	35	100	31,0
WS0123	230	110	270	88,5	7	+ 3,5	35	115	43,5
WS0126	260	112,5	285	88,5	7	+ 4,0	45	150	63,0
WS0130	300	131,5	330	107,5	7	+ 4,0	50	162	91,5
WS0136	360	172	417	140	8	+ 4,0	55	215	146,2
WS0140	400	163,5	400	137	7,5	+ 4,0	55	250	160,4

Ordering example: TSCHAN® S-St

Identifier	Size	d _{1f}	d _{2f}	Further details*)
WS0117	170	75	75	*

*) Without any other specification, we deliver as a standard: with set screws and keyway acc. to DIN 6885-1, keyway side fit P9, bore tolerance H7

Subject to technical change.